

The secret for a successful pool

300W Design & Eurolite

Unavoidable classics, the Hayward Design and Eurolite lights deliver completely effective white lighting. Chosen and approved by a great many users, they are both cost-effective and upgradable as their 300 W halogen light bulb can be replaced by LED bulbs.

The ADVANTAGES

- + Powerful white lighting
- + Design light without visible screws
- + Eurolight light with its hyper sturdy design
- + Can be fitted with LED light bulbs

Design light
Available in dark grey
3481DGR

Design light
Available in light grey
3481LG

Light Design
Available in sand
3481SA



DESIGN

EFFICIENCY

- ▶ Power : 300 W.
- ▶ Power supply voltage :12 V ac.

EXTRA DURABILITY

- ▶ Light's body is molded in improved glass reinforced polymer providing the ultimate strenght.
- ▶ Niche with inside scratches: better lens fixations.
- ▶ Equipment: supplied complete with niche and 90 cm long conduit sheath with 2 threaded ends 3/4", 6 mm² and 2,30m cable.
- ▶ Drilling template (panel version).
- ▶ Caractéristiques : IP68 - class III.

POLYVALENCE

- ▶ For all type of pools.
- ▶ Underwater use only.

EASE OF USE

- ▶ Easy to use due to its stainless clips.

EUROLITE

EFFICIENCY

- ▶ Power : 300 W.
- ▶ Power supply voltage :12 V ac.

EXTRA DURABILITY

- ▶ ABS niche for strength and longer life.
- ▶ Excellent heat proof.
- ▶ Equipment : 6 mm² electric cable 2,3 m, niche of abs, flexible conduit.
- ▶ Characteristics : IP68 to 1 meter depth class III.

POLYVALENCE

- ▶ Underwater use only.

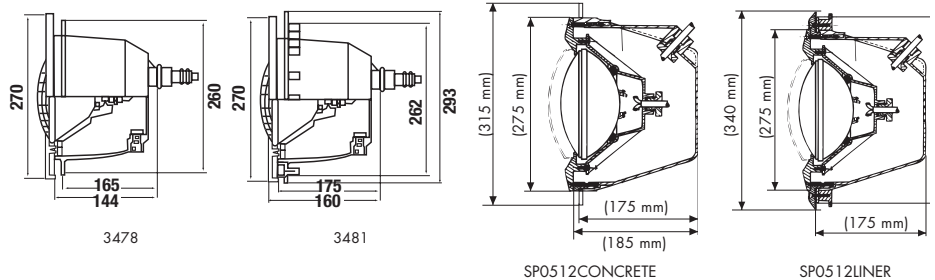

Light Design - 300 W	Item
Light Design Concrete	3478
Light Design Liner	3481
Light Design Panel	3487
Spare part 300W 12V bulb	PRX20005
Design light without niche including bulb, housing, 6 mm ² cable. IP68, class III, certification ENEC.	3486

Light EUROLITE - 300 W	Item
Light Eurolite Concrete	SP0512CONCRETE
Light Eurolite Liner	SP0512LINER
Spare part 300W 12V bulb	PRX20005
Eurolite light without niche including bulb, housing, 6 mm ² cable. IP68, class III, certification ENEC.	SP0512